

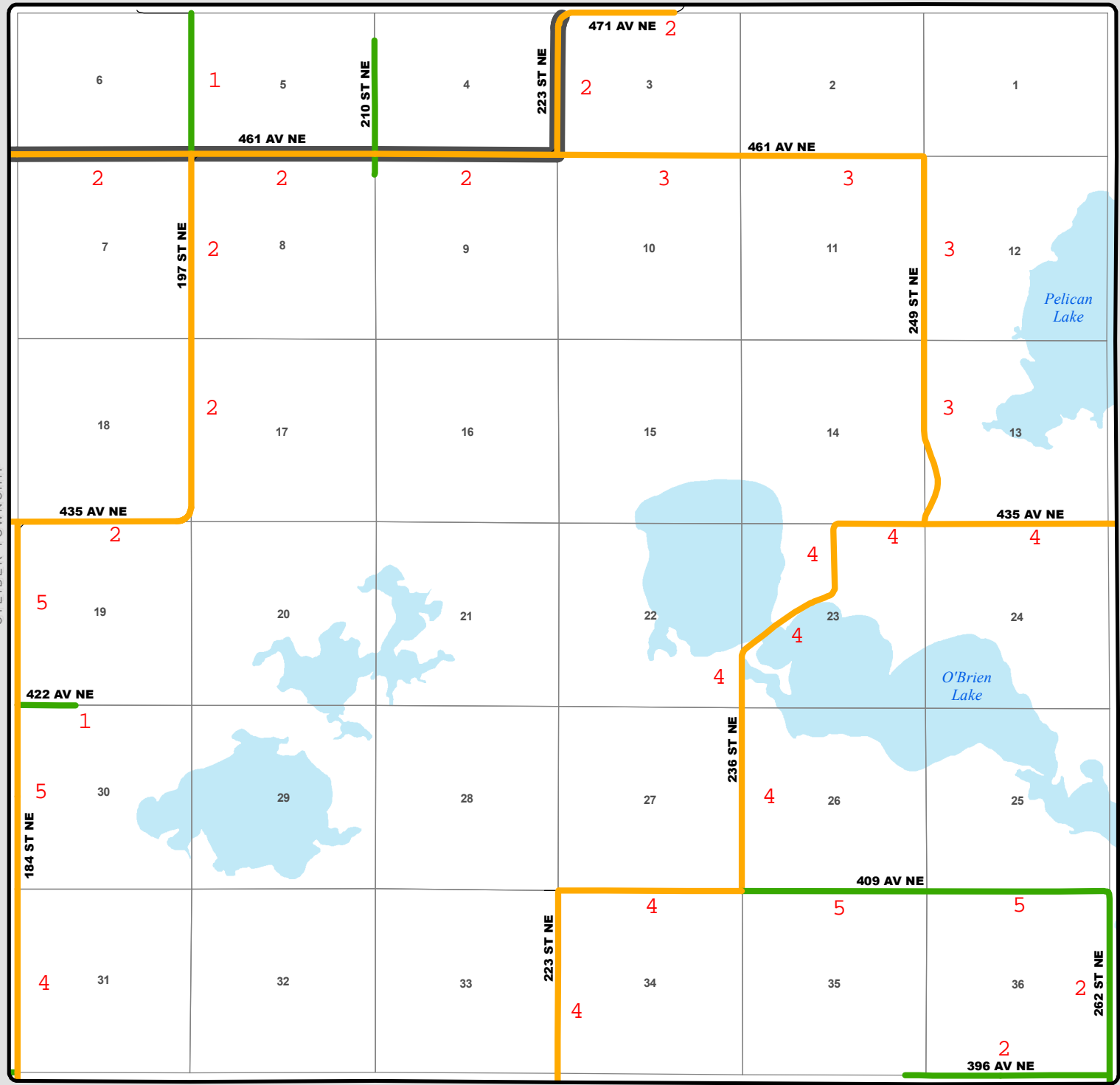

# TOWNSHIP ROAD MAINTENANCE MAP SCHRUNK #12 (T144N R77W)

SHERIDAN COUNTY



STEIBER TOWNSHIP

FLORENCE LAKE TOWNSHIP

CANFIELD TOWNSHIP

- County Gravel Road
- County Paved Road
- Gravel - Summer Maintenance
- Paved - Summer Maintenance
- Gravel - Winter Maintenance
- Gravel - Year Round Maintenance
- Paved - Winter Maintenance
- Paved - Year Round Maintenance
- Township/County Jurisdiction
- Other Roads
- State & Federal Highways
- Federal Aid Road
- Bridge
- Water Pipe