

DOLL SUBDIVISION

OF BURLEIGH COUNTY, NORTH DAKOTA

PART OF THE S1/2 OF THE SW1/4 OF THE SW1/4 OF SECTION 20, T138N-R79W
AND WITHIN THE 1-MILE EXTRA-TERRITORIAL JURISDICTION OF THE CITY OF LINCOLN

767879
Debbie Kroghus

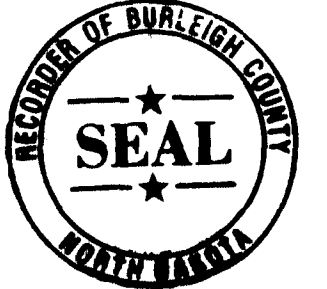

BENCHMARK BISMARCK STATE
JUNIOR COLLEGE GPS STATION
(CORS ID: BSMK) ELEV: 1881.57

NORTH DAKOTA STATE
PLANE COORDINATES:
N = 395830
E = 1922049

UNPLATTED

S89° 49' 41"E 264.00'

15' UTILITY EASEMENT

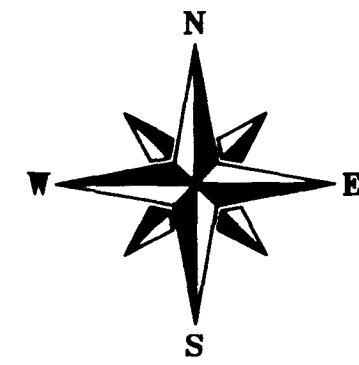

JUNE, 2012

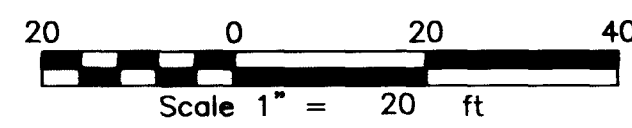

LEGEND

- FOUND REBAR MONUMENT
- PROPERTY CORNER TO BE SET
- △ SECTION/QUARTER CORNER TO BE SET

PARCEL TABLE		
LOT #	SQ FT	ACRES
BLOCK 1		
1	67318	1.55
STREET	19800	0.45
TOTAL	87118	2.00

N00° 33' 19"E 330.00'

255.00'

1

①

EAST BDY SW1/4 OF SW1/4

255.00'

S00° 33' 19"W

330.00'

UNPLATTED

10' UTILITY EASEMENT
S89° 49' 41"E 264.00'

75' ROW 48TH AVENUE SE

SOUTH BDY SW1/4
264.00' N89° 49' 41"W

POINT OF BEGINNING
SE COR OF SW1/4 OF
SW1/4 OF SEC. 20,
T138N-R79W
ND STATE PLANE
COORDINATES:
N = 395499
E = 1922309

Taxes and special assessments paid, all liens created
under section 57-02-08.3 satisfied, if any, and
TRANSFER accepted this 12th day of June, 2012, by
Deputy, Burleigh County Auditor

PROPERTY DESCRIPTION

A TRACT OF LAND BEING A PART OF THE S1/2 OF THE SW1/4 OF THE SW1/4 OF SECTION 20, TOWNSHIP 138 NORTH, RANGE 79 WEST OF THE 5TH PRINCIPAL MERIDIAN, AND WITHIN THE 1-MILE EXTRA-TERRITORIAL JURISDICTION OF THE CITY OF LINCOLN, BURLEIGH COUNTY, NORTH DAKOTA, BEING MORE PARTICULARLY DESCRIBED AS FOLLOWS:

BEGINNING AT THE SOUTHEAST CORNER OF THE SW1/4 OF THE SW1/4 OF SECTION 20, T138N-R79W; THENCE NORTH 89° 49' 41" WEST ALONG THE SOUTH BOUNDARY LINE OF SAID SW1/4 FOR 264.00 FEET; THENCE NORTH 00° 33' 19" EAST FOR 330.00 FEET; THENCE SOUTH 89° 49' 41" EAST FOR 264.00 FEET TO A POINT ON THE EAST BOUNDARY LINE OF SAID SW1/4 OF THE SW1/4; THENCE SOUTH 00° 33' 19" WEST ALONG SAID EAST BOUNDARY LINE FOR 330.00 FEET TO THE POINT OF BEGINNING. SAID TRACT OF LAND CONTAINING 2.00 ACRES, MORE OR LESS.

SURVEYOR'S CERTIFICATE

I, ANDRA L. MARQUARDT, NORTH DAKOTA REGISTERED LAND SURVEYOR NO. 4623, HEREBY CERTIFY THAT I HAVE CAUSED TO BE SURVEYED BY MY FORCES UNDER MY SUPERVISION THE PROPERTY DESCRIBED HEREON AND I HAVE PREPARED THE ACCOMPANYING PLAT; FURTHER, THAT IRON SURVEY MONUMENTS AS SHOWN WILL BE PLACED AFTER THIS PLAT HAS BEEN APPROVED; FURTHER, THAT DISTANCES INDICATED HEREON ARE IN FEET AND HUNDRETHS THEREOF, AND BEARINGS ARE INDICATED IN QUADRANTS AND DEGREES, MINUTES AND SECONDS THEREOF; FURTHER THAT SAID PLAT DOES TRULY SHOW THE SURVEY TO THE BEST OF MY KNOWLEDGE AND BELIEF.

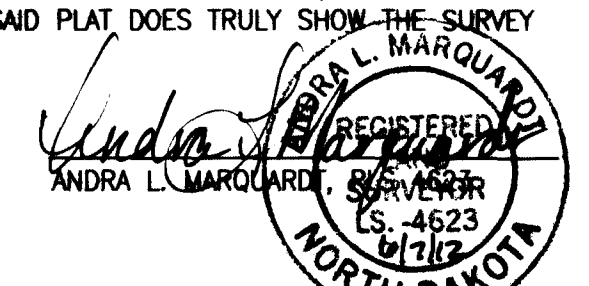

STATE OF NORTH DAKOTA)
)SS
COUNTY OF MORTON)

ON THIS 7th DAY OF June, 2012, THERE APPEARED BEFORE ME ANDRA L. MARQUARDT, KNOWN TO ME TO BE THE PERSON WHOSE NAME IS SUBSCRIBED TO THE ABOVE CERTIFICATE AND DID ACKNOWLEDGE TO ME THAT SHE EXECUTED THE SAME AS HER OWN FREE ACT AND DEED.

HARVEY SCHNEIDER
Notary Public
State of North Dakota
My Commission Expires January 14, 2018

Harvey Schneider
HARVEY SCHNEIDER, NOTARY PUBLIC

OWNERS CERTIFICATE OF DEDICATION

KNOW ALL MEN BY THESE PRESENTS THAT CAMILLUS AND BEVERLY DOLL, BEING THE OWNERS AND PROPRIETORS OF THE PROPERTY SHOWN ON THIS ANNEXED PLAT HAVE CAUSED THAT PORTION DESCRIBED HEREON TO BE SURVEYED AND PLATTED AS "DOLL SUBDIVISION", BURLEIGH COUNTY, NORTH DAKOTA AND DO SO DEDICATE STREETS AS SHOWN HEREON INCLUDING ALL SANITARY, SEWER, WATER, CULVERTS, AND STORM SEWER AND OTHER PUBLIC UTILITY LINES WHETHER SHOWN HEREON OR NOT TO THE PUBLIC USE FOREVER. THEY ALSO DEDICATE EASEMENTS TO RUN WITH THE LAND, FOR GAS, ELECTRIC, TELEPHONE OR OTHER PUBLIC UTILITIES OR SERVICES ON OR UNDER THOSE CERTAIN STRIPS OF LAND DESIGNATED HEREON AS "UTILITY EASEMENTS".

Camillus A Doll
CAMILIUS A. DOLL

Beverly E Doll
BEVERLY E. DOLL

SUBSCRIBED AND SWORN TO BEFORE ME, A NOTARY PUBLIC, THIS 12 DAY OF July, 2012.

ROBERTA UTTERSEHER
Notary Public
State of North Dakota
My Commission Expires Aug. 15, 2012

Roberta Uttersheher
ROBERTA UTTERSEHER, NOTARY PUBLIC
BURLEIGH COUNTY, NORTH DAKOTA
MY COMMISSION EXPIRES: Aug 15, 2012

APPROVAL OF CITY COUNCIL

THE CITY COUNCIL OF THE CITY OF LINCOLN, NORTH DAKOTA HAS APPROVED THE SUBDIVISION OF LAND SHOWN ON THE ANNEXED PLAT, HAS ACCEPTED THE DEDICATION OF ALL STREETS SHOWN HEREON, AND HAS APPROVED THE GROUNDS AS SHOWN ON THE ANNEXED PLAT AS AN AMENDMENT TO THE MASTER PLAN OF THE CITY OF LINCOLN, NORTH DAKOTA. THE FOREGOING ACTION OF THE BOARD OF THE CITY COUNCIL OF THE CITY OF LINCOLN, NORTH DAKOTA, WAS TAKEN BY RESOLUTION APPROVED THE 7th DAY OF JUNE, 2012.

Robert W. Johnston
ROBERT JOHNSTON - MAYOR

Melanie Kitzan
MELANIE KITZAN - ATTEST CITY

APPROVAL OF CITY PLANNING COMMISSION

THE SUBDIVISION OF LAND AS SHOWN ON THE ANNEXED PLAT HAS BEEN APPROVED BY THE PLANNING COMMISSION OF THE CITY OF LINCOLN ON THIS 5th DAY OF JUNE, 2012, IN ACCORDANCE WITH THE LAWS OF THE STATE OF NORTH DAKOTA, ORDINANCES OF THE CITY OF LINCOLN, AND REGULATIONS ADOPTED BY THE SAID PLANNING COMMISSION. IN WITNESS WHEREON ARE SET THE HANDS AND SEALS OF THE CHAIRMAN AND SECRETARY OF THE PLANNING COMMISSION OF THE CITY OF LINCOLN.

Kristopher Schwegel
KRISTOPHER SCHEWEGEL - CHAIRMAN

Janice Sackman
JANICE SACKMAN - SECRETARY

APPROVAL OF CITY ENGINEER

I, BRAD KROGSTAD, REPRESENTING KADRMAS, LEE, & JACKSON, INC., CITY ENGINEER OF THE CITY OF LINCOLN, NORTH DAKOTA, HEREBY APPROVE "DOLL SUBDIVISION" OF BURLEIGH COUNTY, NORTH DAKOTA AS SHOWN ON THE ANNEXED PLAT.

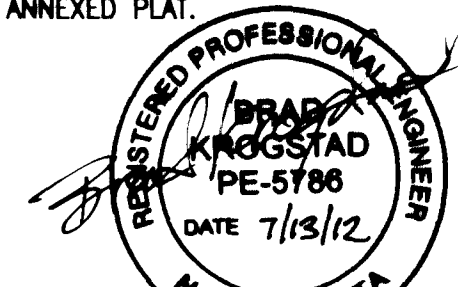

Brad Krogstad
BRAD KROGSTAD, P.E. - CITY ENGINEER

BASIS OF BEARINGS:

THE EAST BOUNDARY LINE OF THE SW1/4 OF SW1/4 OF SECTION 20 AS SURVEYED ON 03/02/2011 AND USING TRIMBLE GPS EQUIPMENT SET UP USING WGS84, GEOID03 (CONUS) COORDINATES: SOUTH 00°33'19" WEST.

BENCHMARK:

BISMARCK STATE COLLEGE GPS STATION (CORS ID: BSMK).

HORIZONTAL DATUM:

NAD83, ND SOUTH ZONE, US SURVEY FOOT

VERTICAL DATUM:

NAVD88, GEOID 2003

OWNERS:
CAMILLUS & BEVERLY DOLL
6900 48TH AVENUE SE
BISMARCK, ND 58504

NOTE: BEARINGS AND DISTANCES MAY VARY FROM PREVIOUS DOCUMENTS OF RECORD DUE TO DIFFERENT METHODS OF FIELD MEASUREMENT.

TE TOMAN ENGINEERING
501 1st Street NW, Mandan, ND 58554
Phone: 701-663-6483 * Fax: 701-663-0923