

TOWNSHIP ROAD MAINTENANCE MAP GHYLIN #11 (T142N R78W)

01/08/2021



ESTHERVILLE TOWNSHIP

ECKLUND TOWNSHIP

ROCK HILL TOWNSHIP

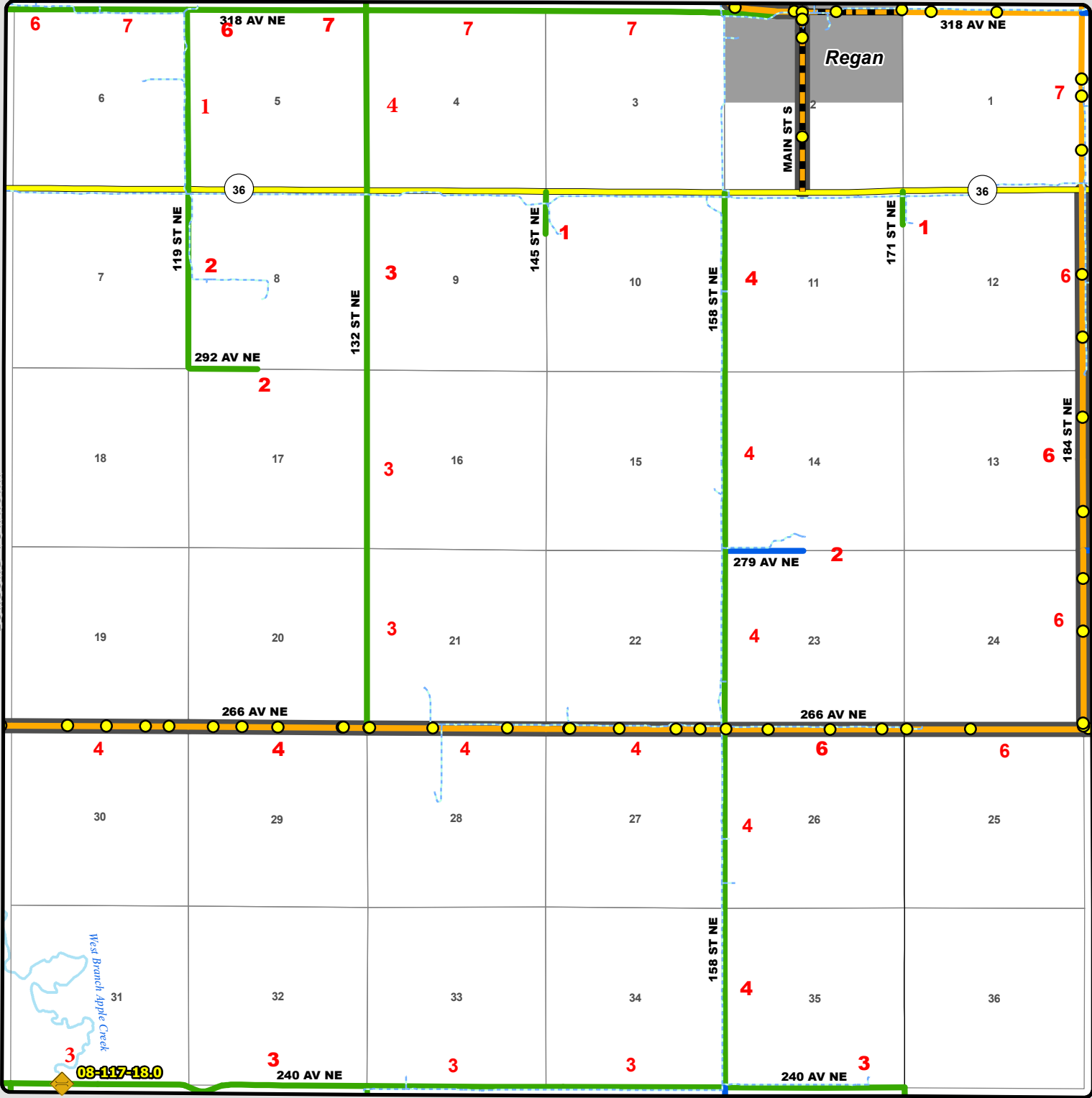

CROMWELL TOWNSHIP

Culvert	County Gravel Road	Gravel - Winter Maintenance	Paved - Winter Maintenance	State & Federal Highways	Bridge
	County Paved Road	Gravel - Year Round Maintenance	Paved - Year Round Maintenance	Federal Aid Road	
	Gravel - Summer Maintenance	Paved - Summer Maintenance	Township/County Jurisdiction	Other Roads	Water Pipe