

# TOWNSHIP ROAD MAINTENANCE MAP GRASS LAKE #3 (T143N R79W)

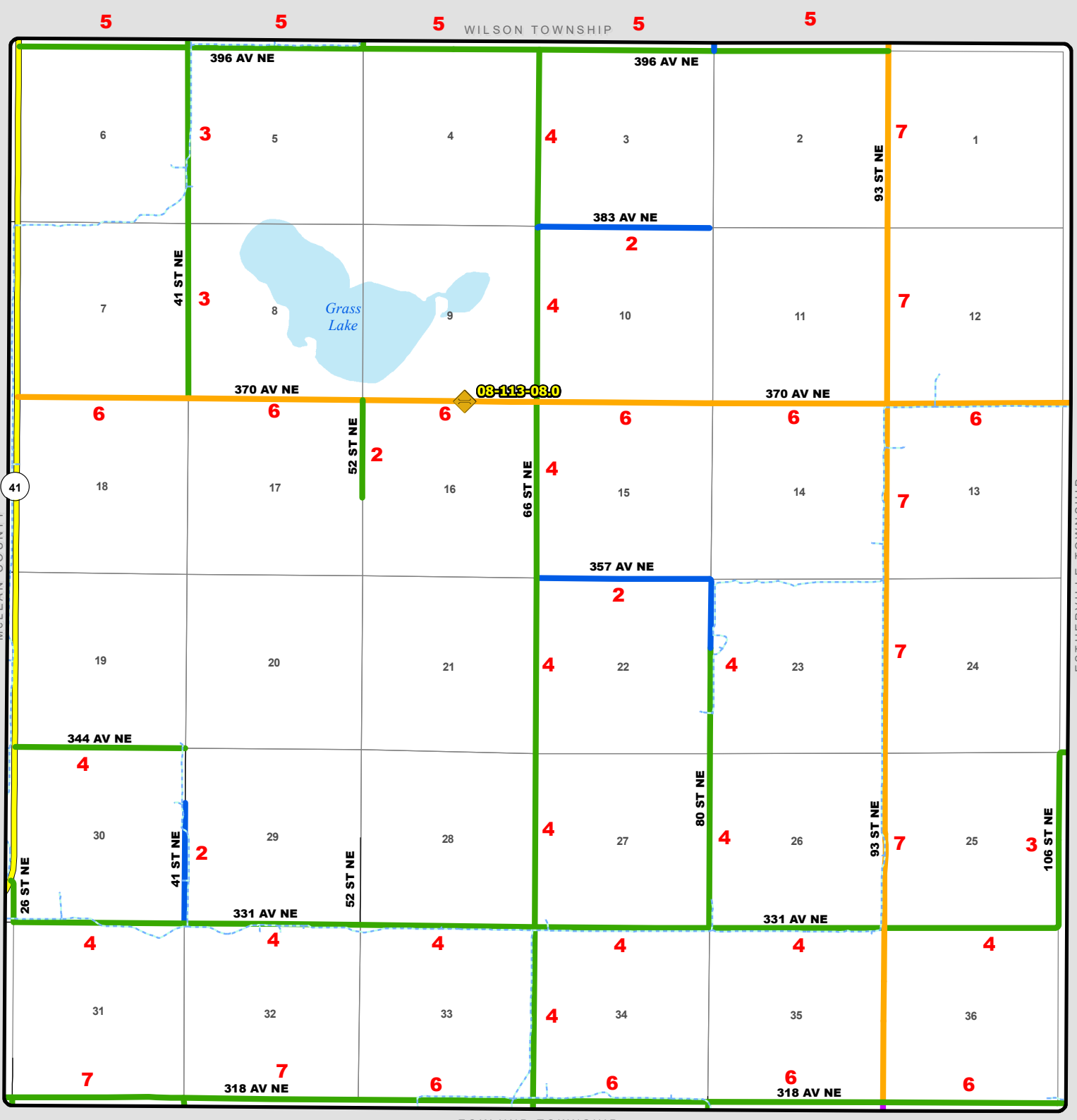

- County Gravel Road
- Gravel - Winter Maintenance
- Paved - Winter Maintenance
- State & Federal Highways
- ◆ Bridge
- County Paved Road
- Gravel - Year Round Maintenance
- Paved - Year Round Maintenance
- Federal Aid Road
- Gravel - Summer Maintenance
- Paved - Summer Maintenance
- Township/County Jurisdiction
- Other Roads
- - - Water Pipe