

TOWNSHIP ROAD MAINTENANCE MAP APPLE CREEK #39 (T138N R79W)

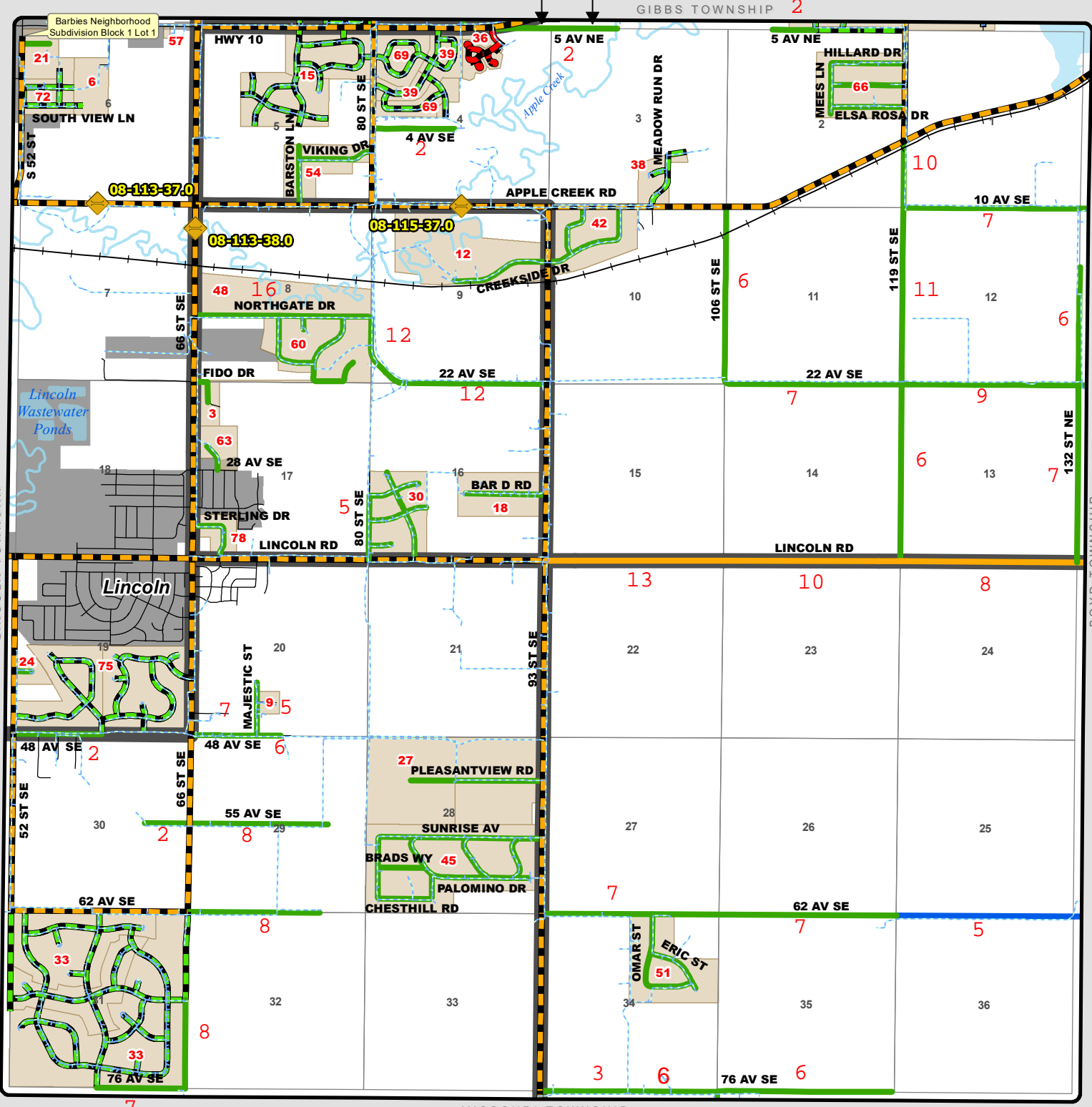

0.11mi Apple Creek 0.58mi Gibbs



- | | | | | |
|-----------------------------|---------------------------------|--------------------------------|--------------------------|------------|
| County Gravel Road | Gravel - Winter Maintenance | Paved - Winter Maintenance | State & Federal Highways | Bridge |
| County Paved Road | Gravel - Year Round Maintenance | Paved - Year Round Maintenance | Federal Aid Road | Water Pipe |
| Gravel - Summer Maintenance | Paved - Summer Maintenance | Township/County Jurisdiction | Other Roads | |

APPLE CREEK SUBDIVISIONS

| CODE | NAME | | SECTION |
|------|--|----|---------|
| 3 | 66TH STREET INDUSTRIAL PARK | 3 | 17 |
| 6 | ABERLE SUBDIVISION | | 6 |
| 9 | ANDERSON ACRES | | 20 |
| 12 | APPLE CREEK ESTATES | 3 | 9 |
| 15 | APPLE MEADOWS 1ST SUBDIVISION | | 5 |
| 15 | APPLE MEADOWS 2ND SUBDIVISION | | 5 |
| 18 | BAR D ESTATES | 3 | 16 |
| 21 | BARBIES NEIGHBORHOOD SUBDIVISION | 2 | 6 |
| 24 | BEULAH MEADOWS SUBDIVISION | 1 | 19 |
| 27 | C AND L ESTATES | 6 | 28 |
| 27 | C AND L ESTATES 2ND ADDITION | | 28 |
| 30 | CITY VIEW HEIGHTS | 2 | 16 |
| 33 | COPPER RIDGE SUBDIVISION | | 31 |
| 33 | COPPER RIDGE 2ND SUBDIVISION | | 31 |
| 33 | COPPER RIDGE 3RD SUBDIVISION | | 31 |
| 36 | APPLE CREEK COUNTRY CLUB 1ST SUBDIVISION | | 4 |
| 36 | APPLE CREEK COUNTRY CLUB 2ND SUB | | 4 |
| 36 | APPLE CREEK COUNTRY CLUB 3RD SUB REP L1 B2 | | 4 |
| 36 | APPLE CREEK COUNTRY CLUB 3RD SUBDIVISION | | 4 |
| 38 | COUNTRY VIEW ESTATES | | 3 |
| 39 | EAST RIDGE 1ST SUBDIVISION | | 4 |
| 39 | EAST RIDGE 2ND SUBDIVISION | | 4 |
| 42 | EAST VALLEY ESTATES | 2 | 10 |
| 45 | FAIMANS SUNRISE ADDITION | 11 | 28 |
| 48 | GEMUENDEN 1ST SUBDIVISION | | 8 |
| 51 | GLASSER SUBDIVISION | 4 | 34 |
| 54 | GOLDEN HEIGHTS SUBDIVISION | 5 | 5 |
| 57 | HIGHWAY SUBDIVISION | | 6 |
| 60 | LEISURE WORLD ESTATES SUBDIVISION | 9 | 8 |
| 63 | MAUCH SUBDIVISION | 4 | 17 |
| 66 | MEES COUNTRY HOME ESTATES | 4 | 2 |
| 69 | PINE MEADOWS SUBDIVISION | | 4 |
| 69 | PINE MEADOWS 2ND SUBDIVISION | | 4 |
| 72 | PRAIRIE VIEW SUBDIVISION | | 6 |
| 75 | PRAIRIEWOOD ESTATES | | 19 |
| 75 | PRAIRIEWOOD ESTATES 2ND | | 19 |
| 78 | SOUTHEAST INDUSTRIAL PARK | 3 | 17 |