

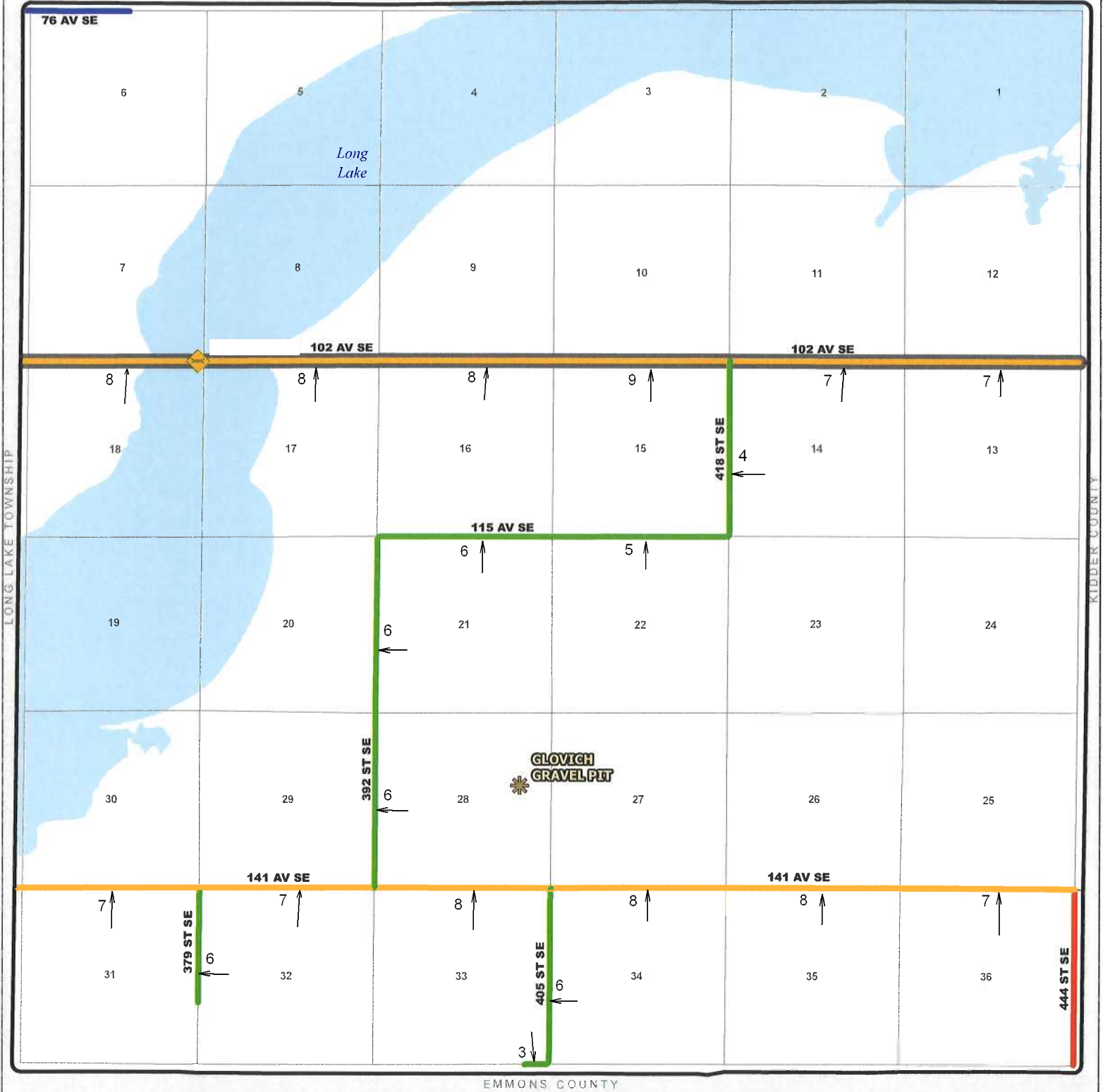

# TOWNSHIP ROAD MAINTENANCE MAP WILDROSE #54 (T137N R75W)

12/08/2014  
N

THELMA TOWNSHIP



LONG LAKE TOWNSHIP

KIDDER COUNTY

EMMONS COUNTY

County Gravel Road	Gravel - Winter Maintenance	Paved - Winter Maintenance	State & Federal Highways	Bridge
County Paved Road	Gravel - Year Round Maintenance	Paved - Year Round Maintenance	Federal Aid Road	Water Pipe
Gravel - Summer Maintenance	Paved - Summer Maintenance	Township/County Jurisdiction	Other Roads	