

# TOWNSHIP ROAD MAINTENANCE MAP BURNT CREEK #24 (T140N R80W)



GLENVIEW TOWNSHIP

CROFTE TOWNSHIP

RIVERVIEW TOWNSHIP

NAUGHTON TOWNSHIP

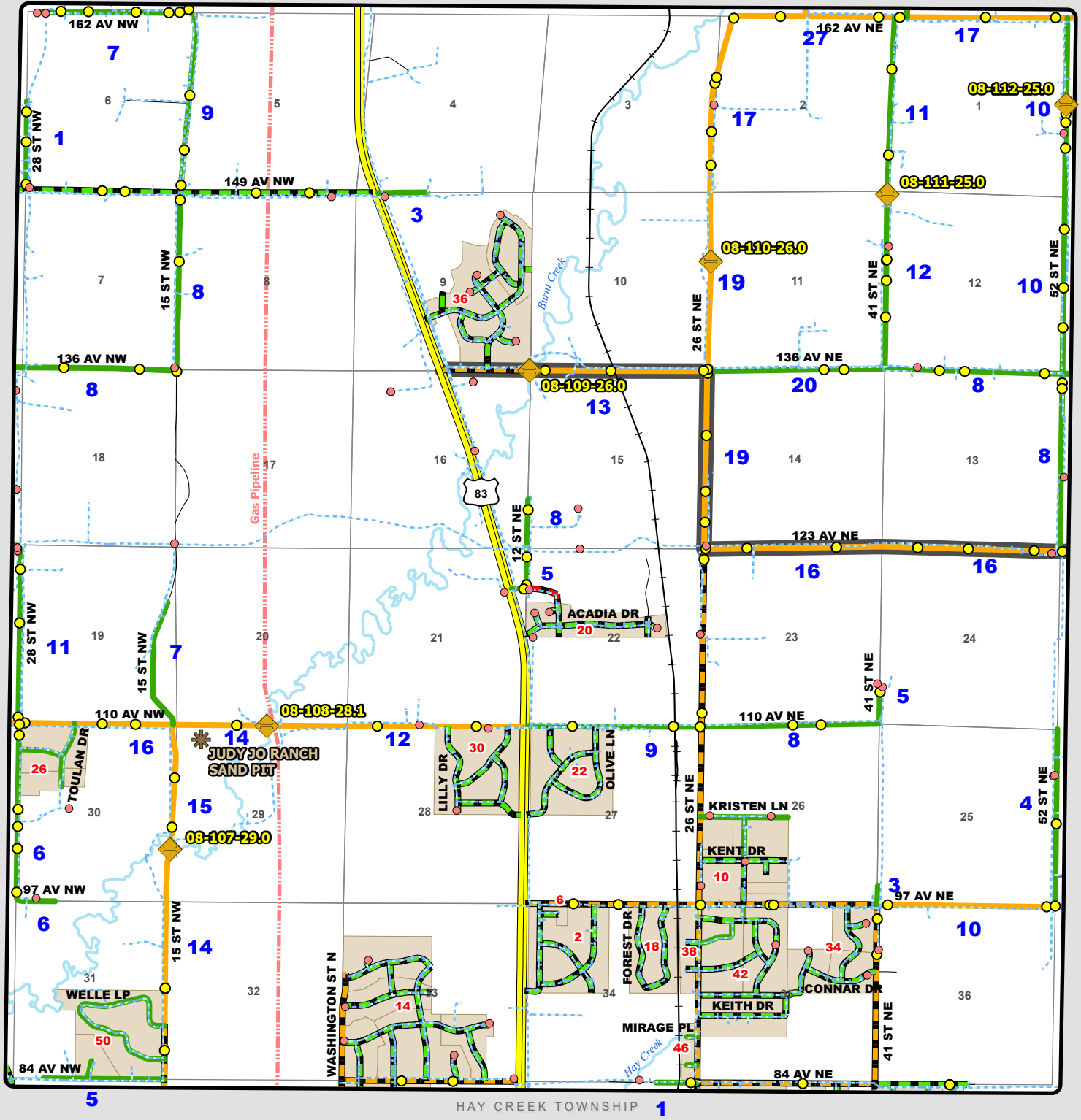

- Culvert
- Fire Hydrants & Cleanouts

- |   |  |   |  |  |
|---|--|---|--|--|
| <span style="display: inline-block; width: 15px; height: 10px; border: 1px solid black; background-color: yellow; margin-right: 5px;"></span> County Gravel Road        | <span style="display: inline-block; width: 15px; height: 10px; border: 1px solid black; background-color: red; margin-right: 5px;"></span> Gravel - Winter Maintenance       | <span style="display: inline-block; width: 15px; height: 10px; border: 1px solid black; background-color: black; margin-right: 5px;"></span> Paved - Winter Maintenance     | <span style="display: inline-block; width: 15px; height: 10px; border: 1px solid black; background-color: yellow; margin-right: 5px;"></span> State & Federal Highways | <span style="display: inline-block; width: 15px; height: 10px; border: 1px solid black; border-radius: 50%; margin-right: 5px;"></span> Bridge |
| <span style="display: inline-block; width: 15px; height: 10px; border: 1px solid black; background-color: black; margin-right: 5px;"></span> County Paved Road          | <span style="display: inline-block; width: 15px; height: 10px; border: 1px solid black; background-color: green; margin-right: 5px;"></span> Gravel - Year Round Maintenance | <span style="display: inline-block; width: 15px; height: 10px; border: 1px solid black; background-color: green; margin-right: 5px;"></span> Paved - Year Round Maintenance | <span style="display: inline-block; width: 15px; height: 10px; border: 1px solid black; background-color: gray; margin-right: 5px;"></span> Federal Aid Road           | <span style="display: inline-block; width: 15px; border-bottom: 1px dashed blue; margin-right: 5px;"></span> Water Pipe                        |
| <span style="display: inline-block; width: 15px; height: 10px; border: 1px solid black; background-color: blue; margin-right: 5px;"></span> Gravel - Summer Maintenance | <span style="display: inline-block; width: 15px; height: 10px; border: 1px solid black; background-color: blue; margin-right: 5px;"></span> Paved - Summer Maintenance       | <span style="display: inline-block; width: 15px; height: 10px; border: 1px solid black; background-color: purple; margin-right: 5px;"></span> Township/County Jurisdiction  | <span style="display: inline-block; width: 15px; height: 10px; border: 1px solid black; margin-right: 5px;"></span> Other Roads  |  |

## BURNT CREEK SUBDIVISIONS

CODE	NAME	SECTION
2	BRENTWOOD ESTATES	34
6	BRENTWOOD ESTATES REPLAT	34
10	FOUR Ks ESTATES	<b>5</b> 26
10	FOUR Ks ESTATES REPLAT	<b>5</b> 26
14	HARVEST GROVE 1ST SUBDIVISION	33
14	HARVEST GROVE 2ND SUBDIVISION	33
14	HARVEST GROVE 3RD SUBDIVISION	33
14	HARVEST GROVE 4TH SUBDIVISION	33
14	HARVEST RIDGE SUBDIVISION	33
18	HAY CREEK PINES SUBDIVISION	34
20	HERITAGE RESERVE SUBDIVISION	22
22	NORTHWOOD ESTATES REPLAT	27
26	PARIS PLACE FIRST SUBDIVISION	<b>5</b> 30
26	PARIS PLACE SECOND SUBDIVISION	<b>5</b> 30
30	PRAIRIECREST 1ST SUBDIVISION	<b>2</b> 28
30	PRAIRIECREST 2ND SUBDIVISION	<b>2</b> 28
34	PRAIRIE PINES 1ST SUBDIVISION	35
34	PRAIRIE PINES 2ND SUBDIVISION	35
34	PRAIRIE PINES 3RD SUBDIVISION	35
36	RANCH SUBDIVISION (THE)	9
36	RANCH 2ND SUBDIVISION (THE)	9
38	RUSTIC ACRES 1ST REPLAT	<b>2</b> 34
42	SHAMROCK ACRES	<b>1</b> 35
42	SHAMROCK ACRES 2ND SUBDIVISION	<b>1</b> 35
42	SHAMROCK ACRES 3RD SUBDIVISION	<b>1</b> 35
46	SUNNY MEADOW ESTATE REPLAT	<b>5</b> 34
50	WELLE 2ND SUBDIVISION	<b>3</b> 31
50	WELLE SUBDIVISION	<b>3</b> 31