

TOWNSHIP ROAD MAINTENANCE MAP STERLING #35 (T139N R76W)

CHRISTIANA TOWNSHIP

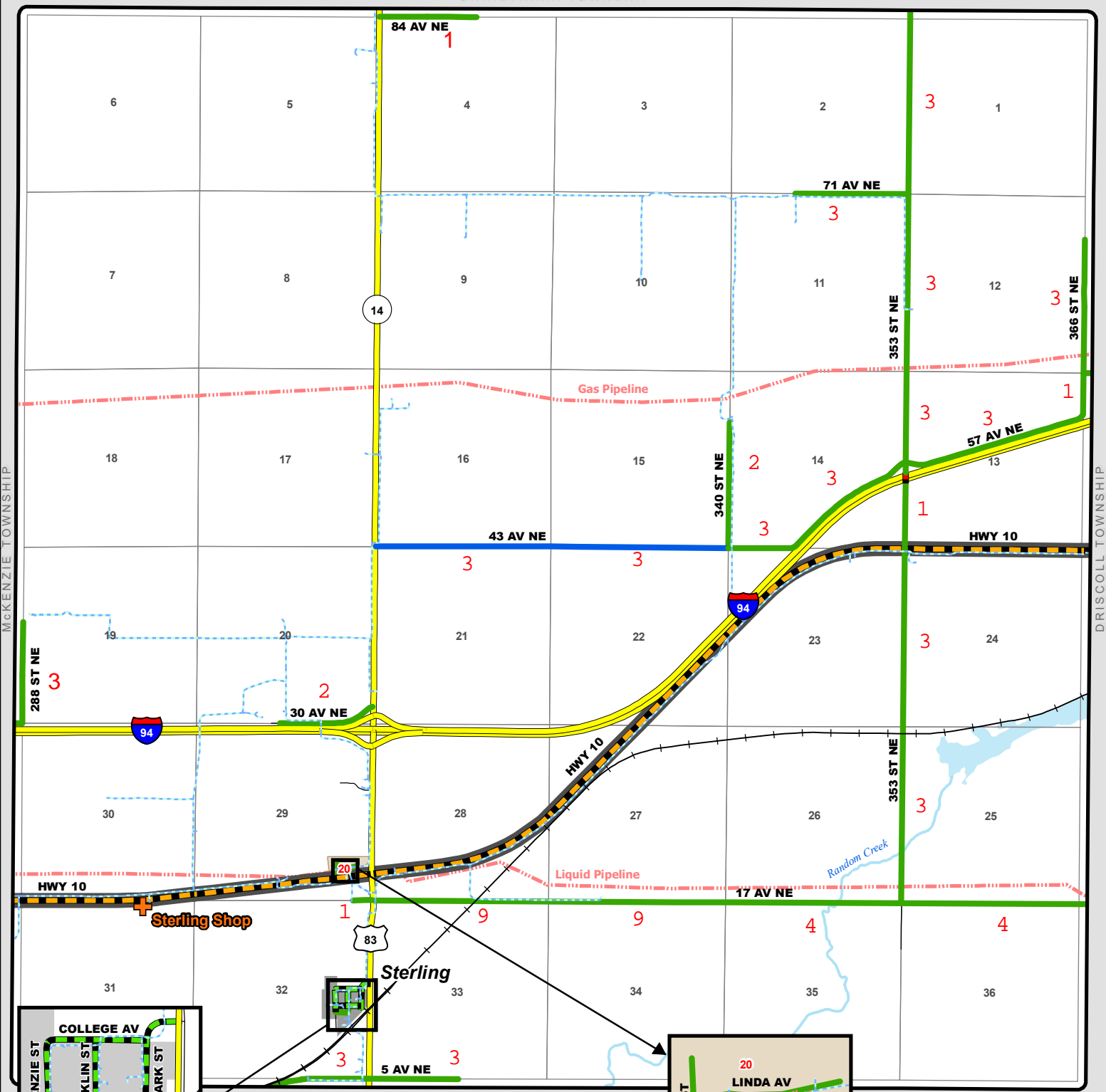

MCKENZIE TOWNSHIP

DRISCOLL TOWNSHIP

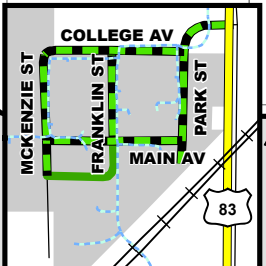

TAFT TOWNSHIP

SUBDIVISIONS
20 - WENTZ SUBDIVISION

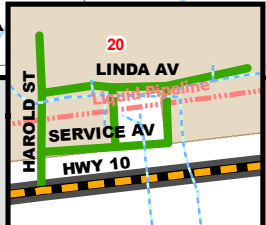

- County Gravel Road
- Gravel - Winter Maintenance
- Paved - Winter Maintenance
- State & Federal Highways
- Bridge
- County Paved Road
- Gravel - Year Round Maintenance
- Paved - Year Round Maintenance
- Federal Aid Road
- Gravel - Summer Maintenance
- Paved - Summer Maintenance
- Township/County Jurisdiction
- Other Roads
- Water Pipe