

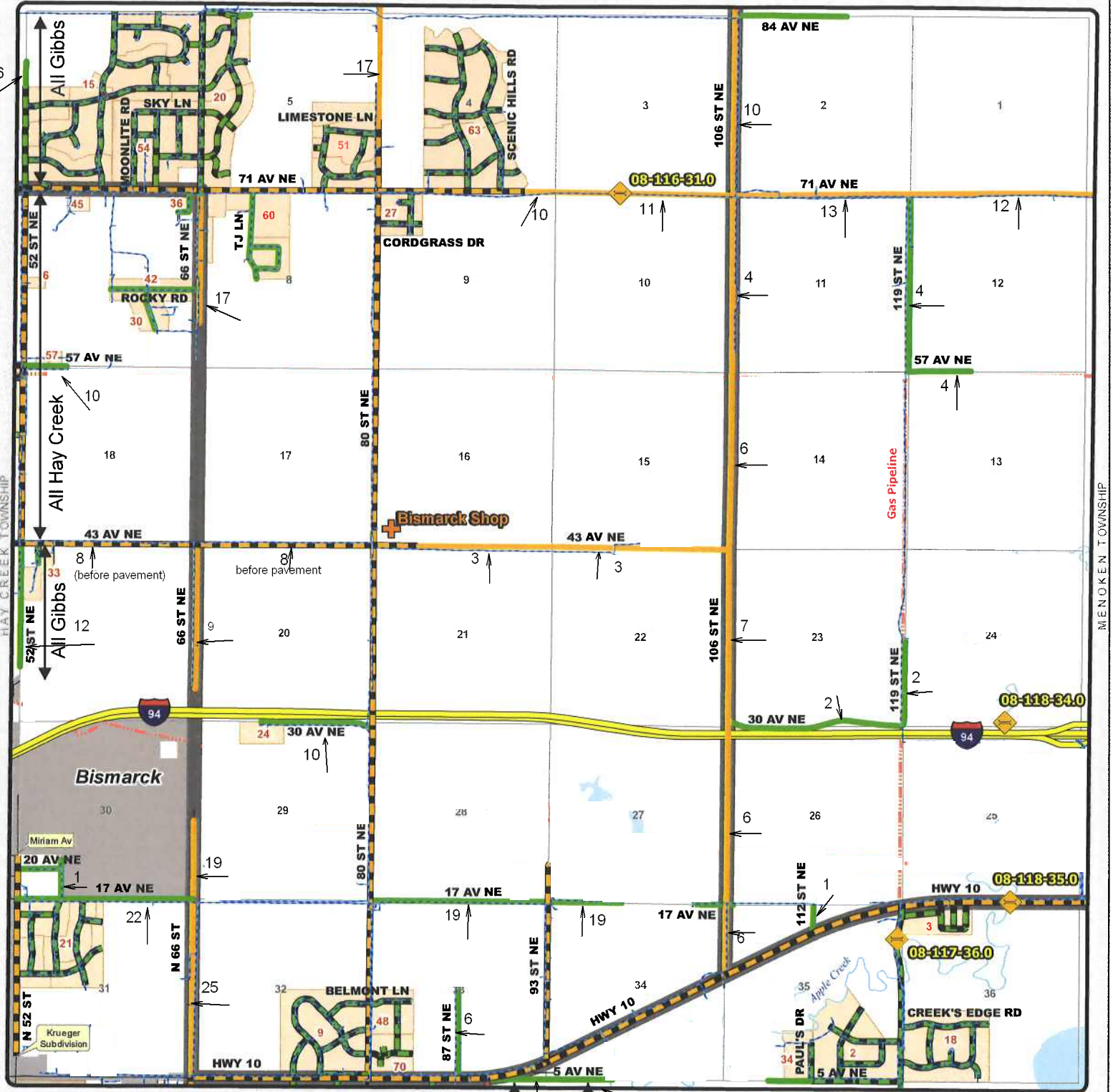

TOWNSHIP ROAD MAINTENANCE MAP GIBBS #32 (T139N R79W)

NAUGHTON TOWNSHIP



0.11mi Apple Creek 0.58mi Gibbs

- | | | | | |
|-----------------------------|---------------------------------|--------------------------------|--------------------------|------------|
| County Gravel Road | Gravel - Winter Maintenance | Paved - Winter Maintenance | State & Federal Highways | Bridge |
| County Paved Road | Gravel - Year Round Maintenance | Paved - Year Round Maintenance | Federal Aid Road | Water Pipe |
| Gravel - Summer Maintenance | Paved - Summer Maintenance | Township/County Jurisdiction | Other Roads | |

GIBBS SUBDIVISIONS

| CODE | NAME | SECTION |
|------|-------------------------------------|---------|
| 2 | APPLE CREEK RIDGE SUBDIVISION | 35 |
| 3 | APPLE VALLEY SUBDIVISION | 36 |
| 6 | BISCHOFF ACRES | 7 |
| 9 | BROOKFIELD ESTATES | 32 |
| 15 | COUNTRY CREEK SUBDIVISION | 6 |
| 15 | COUNTRY CREEK 2ND SUBDIVISION | 6 |
| 15 | COUNTRY CREEK 3RD SUBDIVISION | 6 |
| 15 | COUNTRY CREEK 4TH SUBDIVISION | 6 |
| 15 | COUNTRY CREEK 5TH SUBDIVISION | 6 |
| 18 | COUNTRY MEADOWS SUBDIVISION | 36 |
| 20 | COUNTRY RIDGE 1ST SUBDIVISION | 5 |
| 20 | COUNTRY RIDGE 2ND SUBDIVISION | 5 |
| 21 | COUNTRYSIDE ESTATES SUBDIVISION | 31 |
| 21 | COUNTRYSIDE ESTATES 2ND SUBDIVISION | 31 |
| 21 | COUNTRYSIDE ESTATES 3RD SUBDIVISION | 31 |
| 21 | COUNTRYSIDE ESTATES 4TH SUBDIVISION | 31 |
| 21 | COUNTRYSIDE ESTATES 5TH SUBDIVISION | 31 |
| 24 | DAUENHAUER ADDITION | 29 |
| 27 | EAST MEADOWS ESTATES | 9 |
| 30 | FOREST PARK 1ST SUBDIVISION | 13 7 |
| 33 | HUBER SUBDIVISION | 5 19 |
| 34 | JASKOWIAK SUBDIVISION | 35 |
| 36 | JRJ ADDITION | 6 7 |
| 42 | NORTH FORTY ESTATES REPLAT | 15 7 |
| 45 | PAPACHEKS SUBDIVISION | 7 |
| 48 | RAINBOW ACRES | 33 |
| 51 | ROCK CREEK 1ST SUBDIVISION | 5 |
| 51 | ROCK CREEK 2ND SUBDIVISION | 5 |
| 51 | ROCK CREEK 3RD SUBDIVISION | 5 |
| 51 | ROCK CREEK 4TH SUBDIVISION | 5 |
| 54 | SKYLINE ESTATES | 6 |
| 57 | TRIANGLE SQUARE SUBDIVISION | 7 |
| 57 | TRIANGLE SQUARE 2ND SUBDIVISION | 7 |
| 60 | TJ RANCH ESTATES | 13 8 |
| 60 | TJ RANCH ESTATES 2ND ADDITION | 8 |
| 60 | TJ RANCH ESTATES REPLAT L1&2 B1 | 8 |
| 60 | TJ RANCH ESTATES REPLAT L6&7 B2 | 8 |
| 63 | COUNTRY HILLS SUBDIVISION | 4 |
| 63 | COUNTRY HILLS 2ND SUBDIVISION | 4 |
| 70 | WILLOW VIEW ESTATES | 33 |