

# TOWNSHIP ROAD MAINTENANCE MAP ECKLUND #10 (T142N R79&80W)

GHYLIN TOWNSHIP

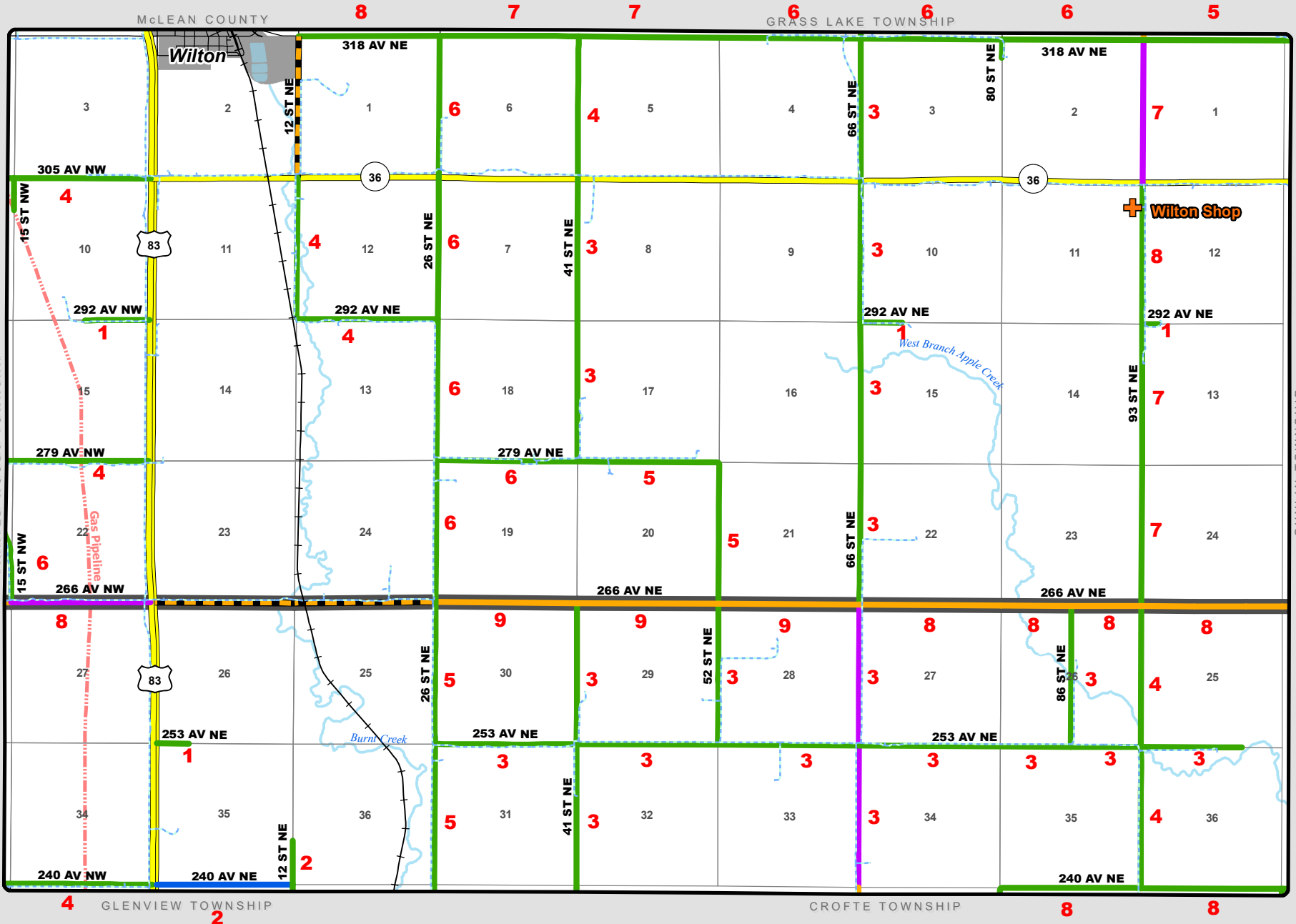

- County Gravel Road
- County Paved Road
- Gravel - Summer Maintenance
- Gravel - Winter Maintenance
- Gravel - Year Round Maintenance
- Paved - Summer Maintenance
- Paved - Winter Maintenance
- Paved - Year Round Maintenance
- Township/County Jurisdiction
- State & Federal Highways
- Federal Aid Road
- Other Roads
- Bridge
- Water Pipe

McLEAN COUNTY

GRASS LAKE TOWNSHIP

GLENVIEW TOWNSHIP

CROFTE TOWNSHIP

Wilton

Wilton Shop

83

83

4

2

8

7

7

6

6

6

5

6

4

3

7

4

10

6

7

3

3

8

1

11

4

12

6

8

3

10

1

12

4

14

4

13

6

18

3

15

7

13

6

22

6

19

6

5

3

22

7

24

8

27

5

30

9

9

3

9

8

8

1

26

1

25

3

9

3

8

8

8

3

35

3

31

3

3

3

3

3

3

4

34

5

32

3

3

3

3

4

36

4

2

8

8