

TOWNSHIP ROAD MAINTENANCE MAP TELFER #46 (T137N R78W)

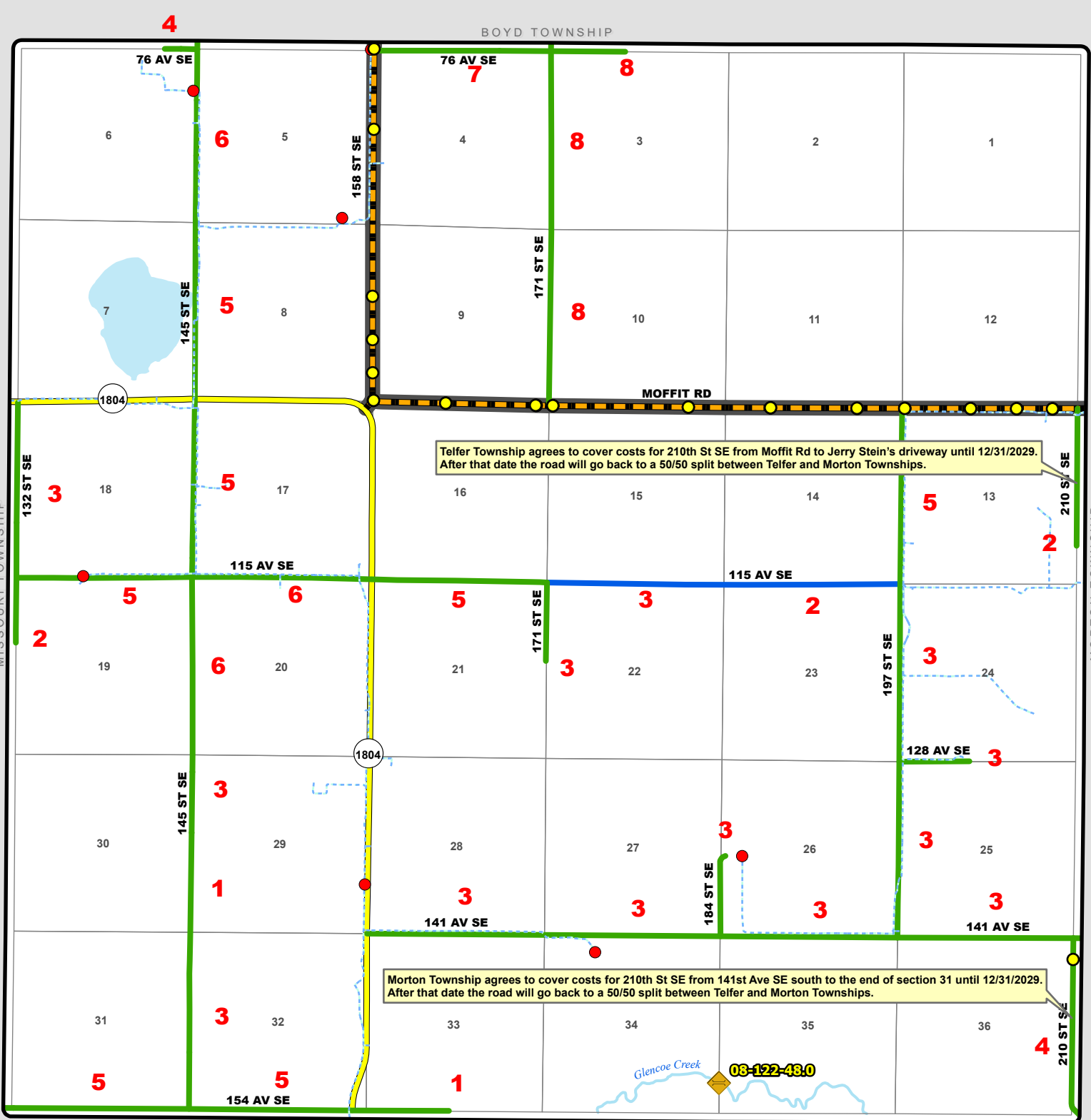

Telfer Township agrees to cover costs for 210th St SE from Moffit Rd to Jerry Stein's driveway until 12/31/2029. After that date the road will go back to a 50/50 split between Telfer and Morton Townships.

Morton Township agrees to cover costs for 210th St SE from 141st Ave SE south to the end of section 31 until 12/31/2029. After that date the road will go back to a 50/50 split between Telfer and Morton Townships.

Culvert	Gravel - Winter Maintenance	Paved - Winter Maintenance	State & Federal Highways	Bridge
County Paved Road	Gravel - Year Round Maintenance	Paved - Year Round Maintenance	Federal Aid Road	Water Pipe
Gravel - Summer Maintenance	Paved - Summer Maintenance	Township/County Jurisdiction	Other Roads	