

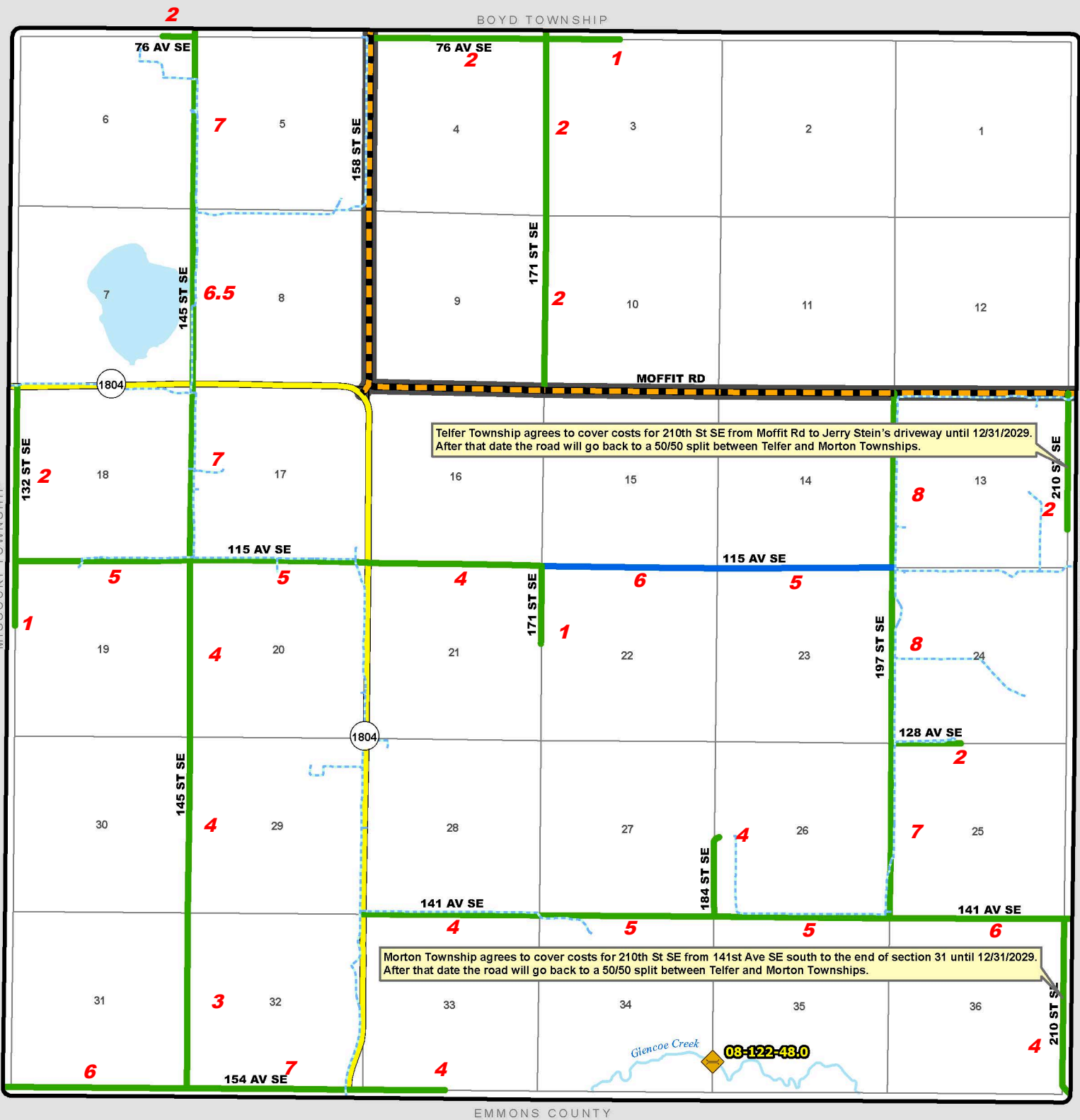

# TOWNSHIP ROAD MAINTENANCE MAP TELFER #46 (T137N R78W)



Telfer Township agrees to cover costs for 210th St SE from Moffit Rd to Jerry Stein's driveway until 12/31/2029. After that date the road will go back to a 50/50 split between Telfer and Morton Townships.

Morton Township agrees to cover costs for 210th St SE from 141st Ave SE south to the end of section 31 until 12/31/2029. After that date the road will go back to a 50/50 split between Telfer and Morton Townships.

- County Gravel Road
- Gravel - Winter Maintenance
- Paved - Winter Maintenance
- State & Federal Highways
- Bridge
- County Paved Road
- Gravel - Year Round Maintenance
- Paved - Year Round Maintenance
- Federal Aid Road
- Water Pipe
- Gravel - Summer Maintenance
- Paved - Summer Maintenance
- Township/County Jurisdiction
- Other Roads